

STAGE 8

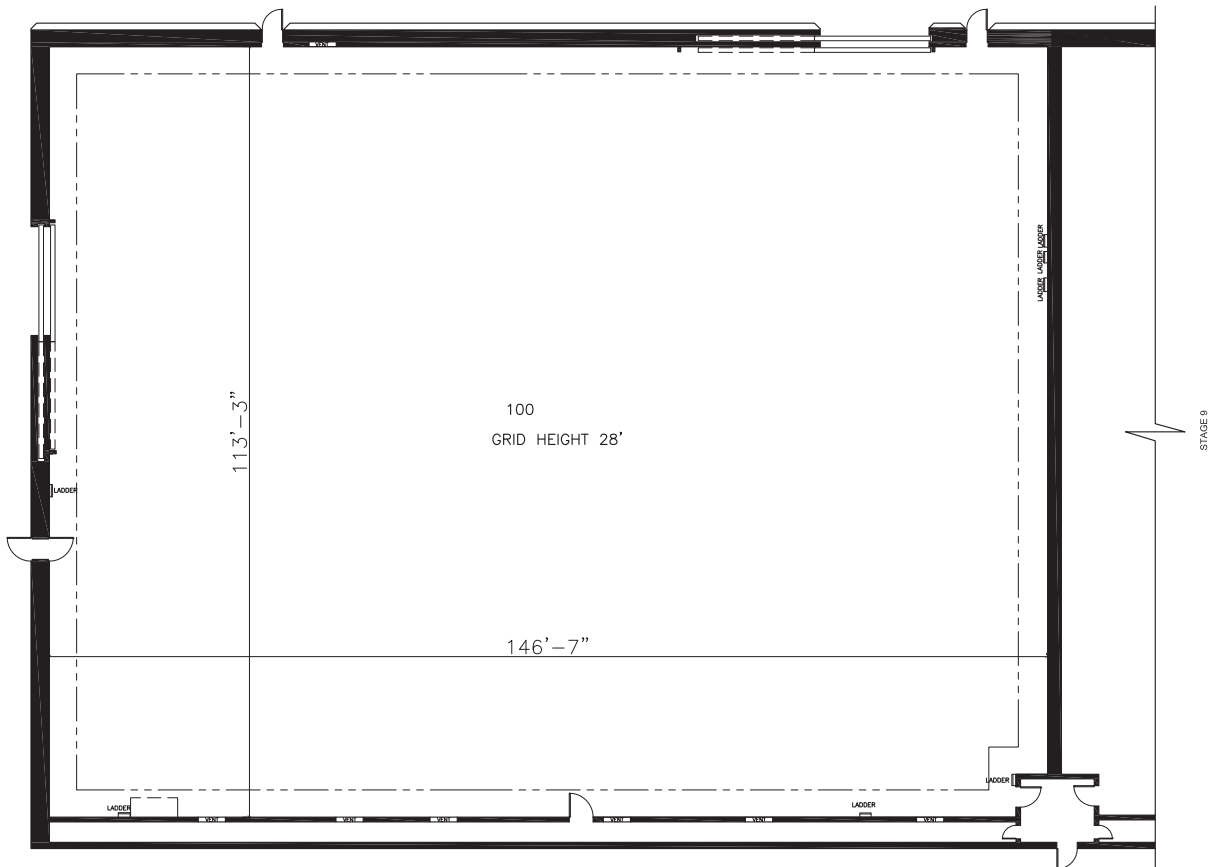

FLOORPLAN



DIMENSIONS

| | |
|---------------------|-----------|
| Width | 113'-3" |
| Length | 146'-7" |
| Height | 30' |
| Square Feet | 16,594 |
| Door Height | 26' & 27' |
| Max Weight Capacity | 10,000lbs |

PREVIOUS PRODUCTIONS SHOT ON THIS STAGE:

Movies

Darling Lili (1970)
 Rosemary's Baby (1968)
 Going My Way (1944)
 Lady Sings the Blues (1972)
 Seven Days In May (1964)
 Breakfast at Tiffany's (1961)
 But Not For Me (1959)
 Houseboat (1958)
 The Matchmaker (1958)
 Road to Bali (1952)
 Detective Story (1951)

Television

Star Trek Voyager
 Star Trek: The Next
 Generation
 Star Trek
 (Original Series)
 Star Trek Enterprise

STAGE 8



STAGE LOCATION

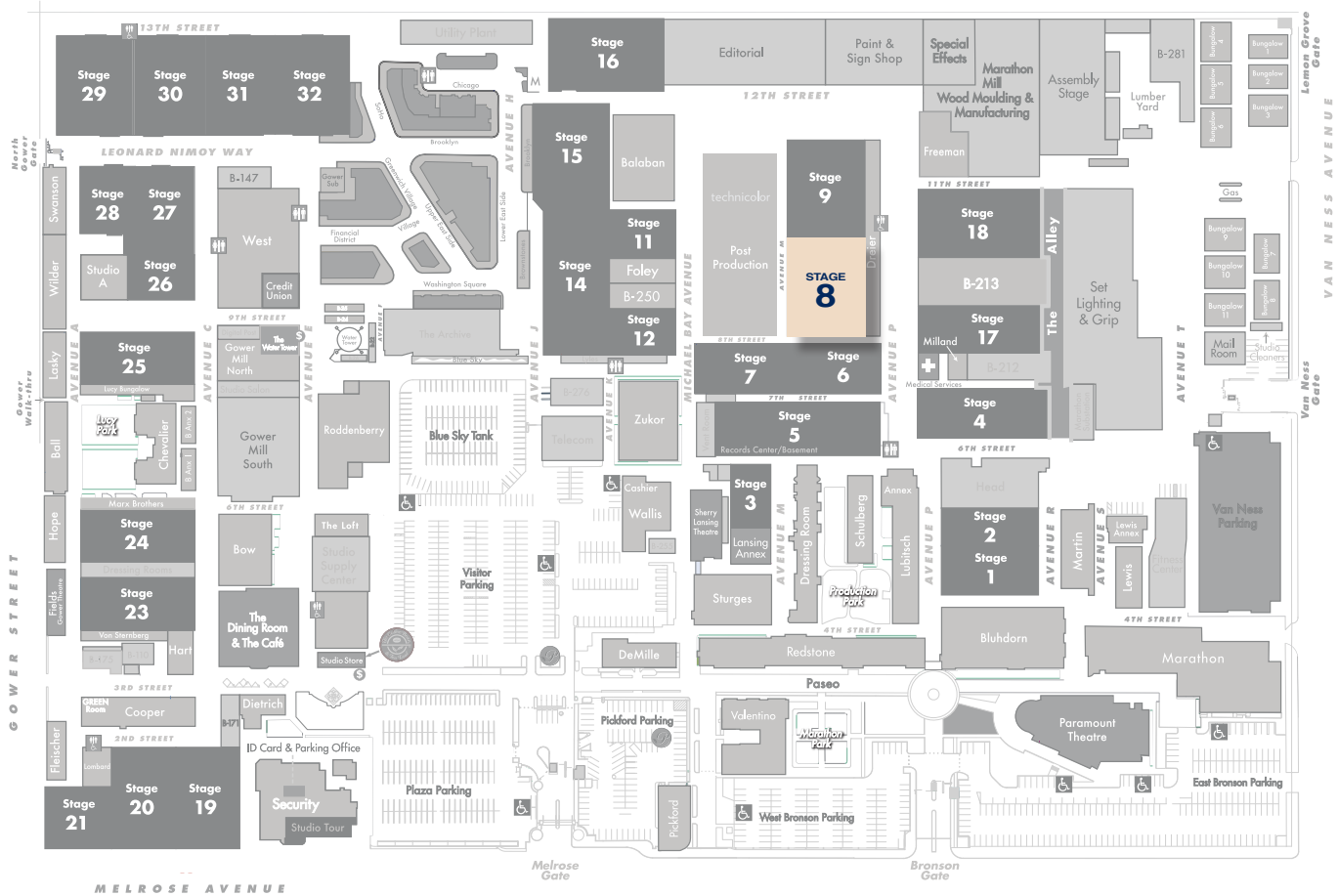

SPECIFICATIONS

| | |
|---------------------------------|---------------|
| Power* | 3,600A |
| HVAC | 200T |
| Red Light Controlled | Yes |
| Heat | Yes |
| Utilities (Air at 90PSI) | G/W/A |
| Wi-Fi Internet Access | |

*(IP2W fixed AC power (cam locks) available as 120/208V 3P4W)